

1
13
SMALL WALL (BUILD 2)
SCALE: 1/2" = 1'-0"

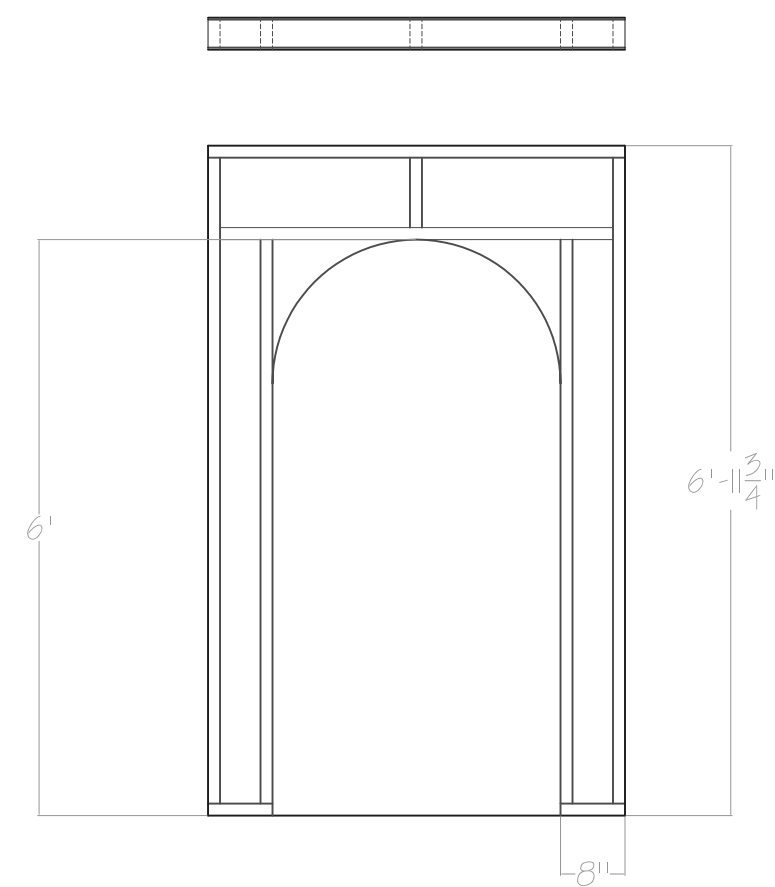

2
13
DOOR WALL (BUILD 2)
SCALE: 1/2" = 1'-0"

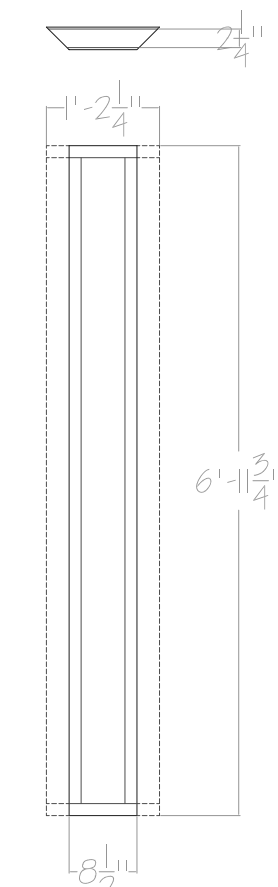

3
13
ANGLE WALL (BUILD 4)
SCALE: 1/2" = 1'-0"

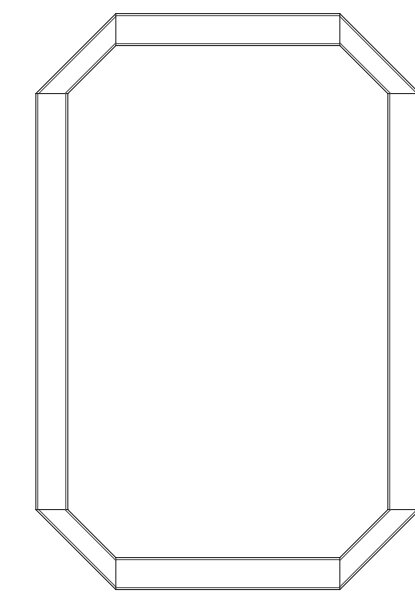

4
13
WALL TOP VIEW
SCALE: 1/2" = 1'-0"

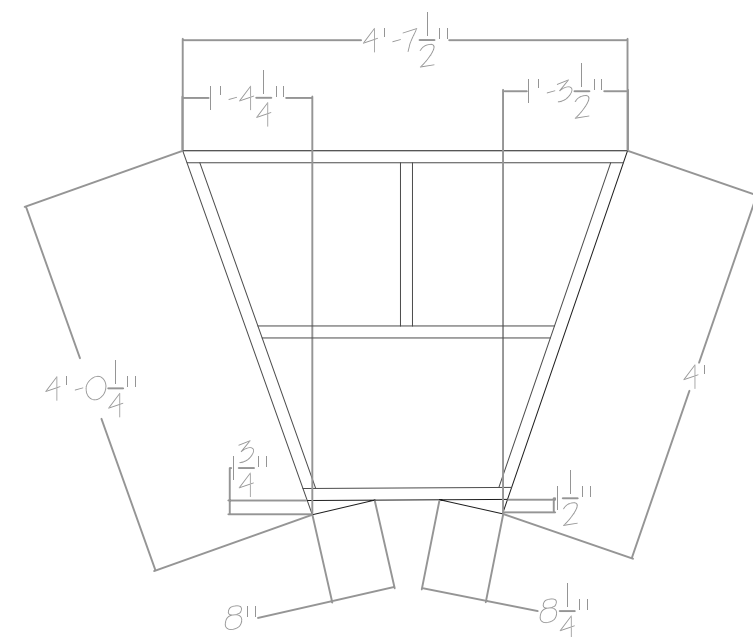

5
13
TOP STAIR - BUILD 1
SCALE: 1/2" = 1'-0"

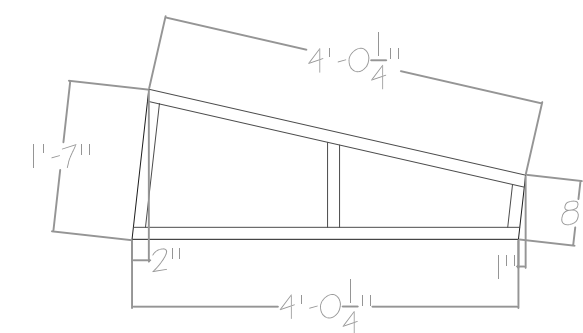

6
13
OTHER STAIRS - BUILD 6
SCALE: 1/2" = 1'-0"

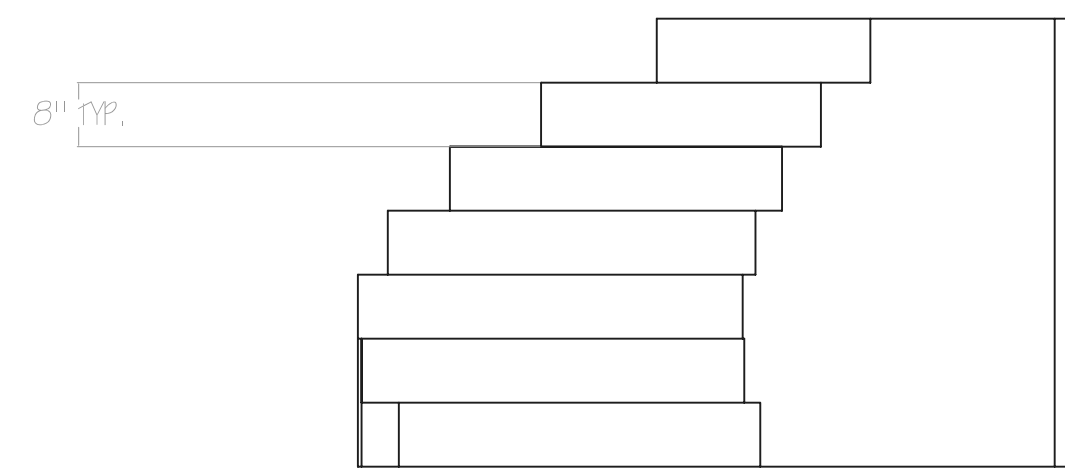

7
13
STAGE RIGHT STAIR - SIDE VIEW A
SCALE: 1/2" = 1'-0"

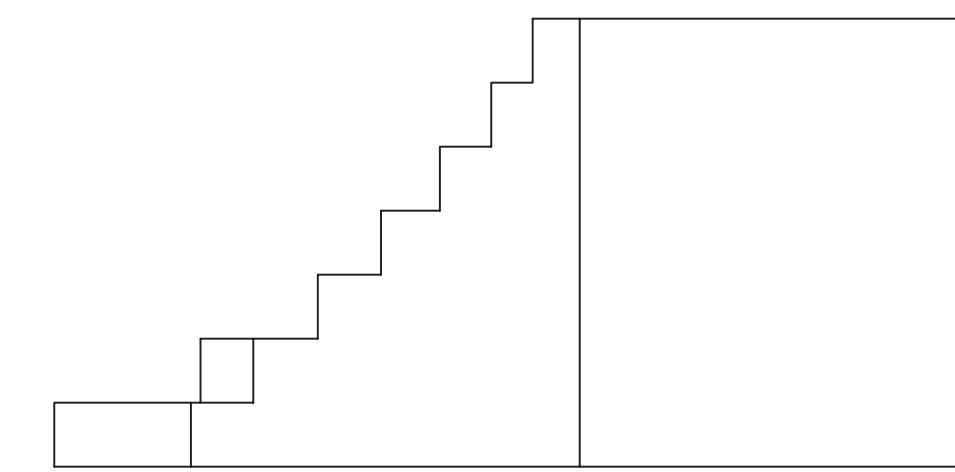

8
13
STAGE RIGHT STAIR - SIDE VIEW B
SCALE: 1/2" = 1'-0"

MICHIGAN STATE UNIVERSITY - FAIRCHILD THEATRE			
THE RAKE'S PROGRESS			
TECH ELEVATIONS			DWG. NO.
DIRECTOR: MELANIE HELTON			13
DESIGNER: KIRK POMER			OF 5
TECH DIRECTOR: JONATHAN T. SAGE			CDP:
DRAWN BY: JONATHAN T. SAGE			DATE:
APPROVED:	DATE:	SCALE:	DRAWING DATE:
		1/2" = 1'-0"	02-23-2009